

Installation Guidelines

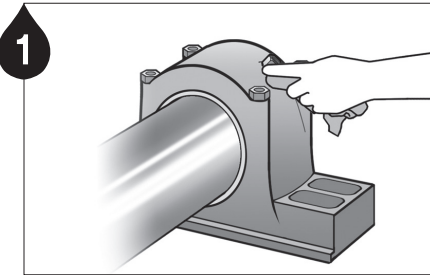

1

Remove contaminants around the lube point.

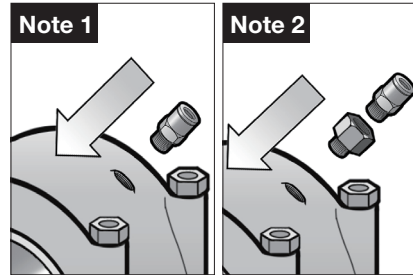

Note 1

Note 2

Note 1 Install A240, a push-in type tube fitting, directly onto the lube point.

Note 2 If necessary, use appropriate adaptors to install A240.

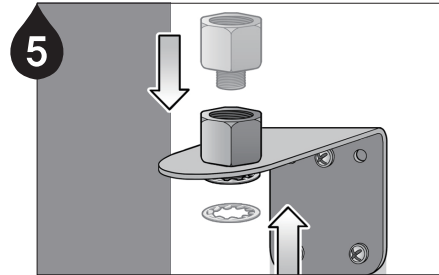

5

Install the adaptor (A002) on the fixed mounting bracket with the washer (B058) on the bottom.

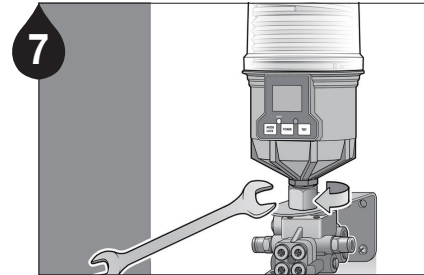

7

Install the lubricator onto the mounting bracket using a 17mm wrench.

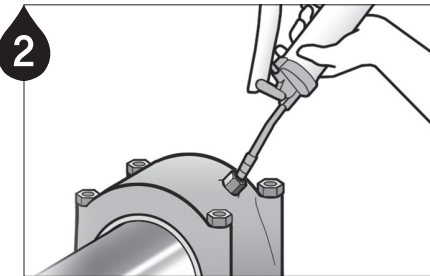

2

Ensure a clear passage using a manual grease gun. **Note 1** Remove any hardened grease by purging the lube point with a manual grease gun. **Note 2** The grease in the equipment and the grease contained in the unit should be the same or compatible.

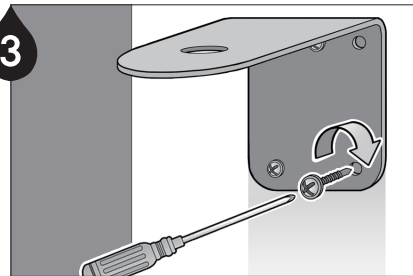

3

Install the mounting bracket (B002) at a proper location using screws (B051).

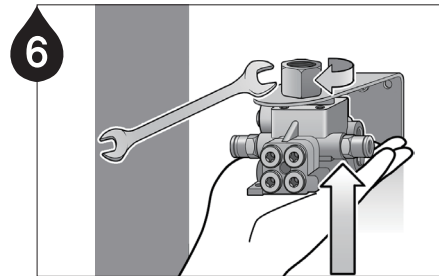

6

Connect the divider block to the adaptor, washer, and mounting bracket and turn the adaptor (A002) clockwise to tighten.

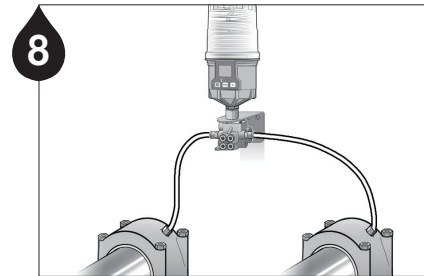

8

For typical bearing applications, install the divider block to the equipment using either copper or nylon tubes.

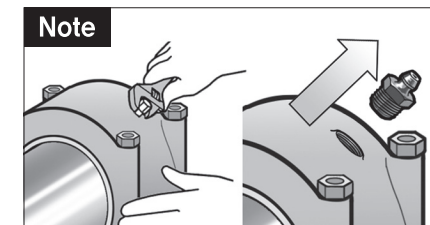

Note

Remove the grease nipple.

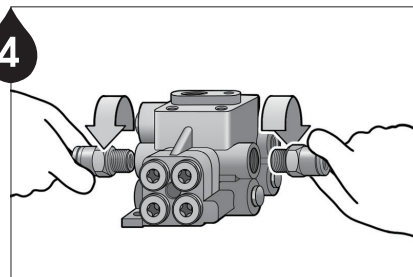

4

Screw in the push-in fitting connectors to each port of the divider block.

Note 1 It is recommended to seal the connected fittings using a thread sealant product (Loctite 572,577).

Note 2 Use a 90° push-in swivel fitting when applicable.

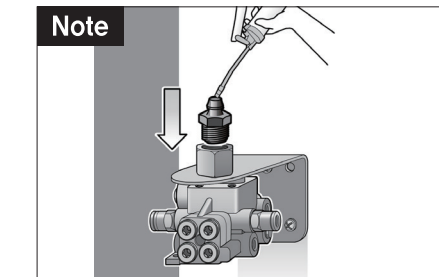

Note

Prefill the divider block with the same or compatible grease using a grease gun and a 3/8" grease nipple.

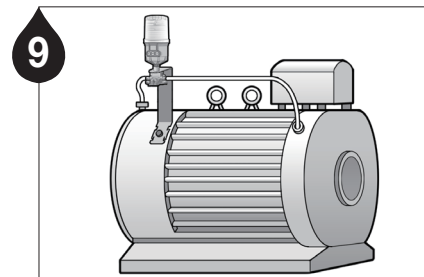

9

For motor bearing applications, install the mounting bracket at a proper location using the 2 point remote installation kit and then connect the lube-lines to both bearings.

Mounting Method

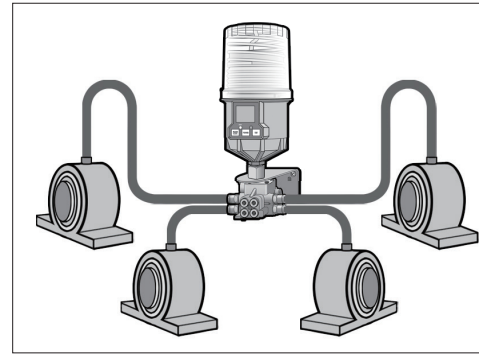

Multi-Point Installation

Remote multi-point lubrication is available with the Pulsarlube M using a divider block. It is recommended to test the back pressure of the bearing, lube lines, and divider block after assembly using a grease gun connected to a pressure gauge. Ensure the break-off pressure is below the average operating pressure of 30bar (435psi).

Warning

- ▶ Do not plug any open ports on the divider block. The kit or divider block must be ordered with the appropriate number of points required.
- ▶ For remote installation using a 6mm I.D. tubing, keep the maximum distance at 6m (20ft) or less.
- ▶ Prior to installation, ensure a clear passage using a manual grease gun and be sure to test the lubricator for proper operation.

Divider Block Grease Volume

Part No.	Outlet No.	
DU - 2RS	1 / 2	
DU - 3RS	1 / 2 / 5	No.2 / twice as much
DU - 4RS	1 / 2 / 5 / 6	
DU - 5RS	1 / 2 / 3 / 5 / 6	No.3 / twice as much
DU - 6RS	1 / 2 / 3 / 5 / 6 / 7	
DU - 7RS	1 / 2 / 3 / 5 / 6 / 7 / 8	No.8 / twice as much
DU - 8RS	1 / 2 / 3 / 4 / 5 / 6 / 7 / 8	

Note 1 The average dispensing volume of each port is about 0.3ml EXCEPT No.2 of DU-3RS, No.3 of DU-5RS, and No.8 of DU-7RS. The three ports above will dispense double the amount of grease as the other ports.

Note 2 The Outlet No. is shown near each port on the divider block.

Detailed Parts

No.	Part No.	Available Kits & Component Parts							
		1250MD-2	1250MD-3	1250MD-4	1250MD-5	1250MD-6	1250MD-7	1250MD-8	
①	M unit	Sold separately							
②	A002	1ea							
③	B002	1ea							
④	B051	3ea							
⑤	B058	1ea							
⑥	A240	4ea	6ea	8ea	10ea	12ea	14ea	16ea	
⑦	DU-XRS	DU-2RS	DU-3RS	DU-4RS	DU-5RS	DU-6RS	DU-7RS	DU-8RS	
⑧	A243 (USA only)	2ea	3ea	4ea	5ea	6ea	7ea	8ea	
⑨	A214-1	1ea	2ea	2ea	3ea	3ea	4ea	4ea	

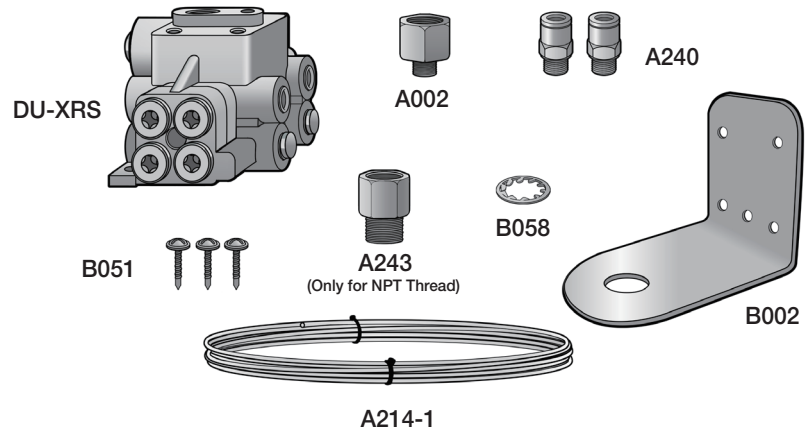

PULSARLUBE

The World Leader of Automatic Lubrication

Pulsarlube USA, Inc.
 1480 Howard Street, Elk Grove Village, IL 60007, USA
 TEL:1-847-593-5300 FAX:1-847-593-5303 www.pulsarlube.com / info@pulsarlube.com

Warranty Product warranty is limited to original defects in material and workmanship and will not cover any collateral damage due to mishandling, abuse and /or any other inappropriate use of this product.

